



## Parks, Recreation, & Culture

### Invitation to Tender No. 2023-PRC-06

### Arts and Heritage Hub ADDENDUM #4

**For further information:**  
Contact: Chris Barfoot  
[cbarfoot@ladysmith.ca](mailto:cbarfoot@ladysmith.ca)  
250.245.6421

<b>Tender Issue Date:</b>	Thursday, June 29, 2023
<b>Addendum #1:</b>	Thursday, July 6, 2023
<b>Addendum #2:</b>	Thursday, July 31, 2023
<b>Addendum #3:</b>	Thursday, August 10, 2023
<b>Addendum #4:</b>	Monday, August 14, 2023
<b>Site Visit:</b>	10:00 a.m., Friday, August 11, 2023
<b>Tender Closing:</b>	2:00 p.m., Thursday, August 24
<b>Tender Opening:</b>	2:15 p.m., Thursday, August 24, Ladysmith City Hall



## **Addendum #4: Invitation to Tender (ITT) No. 2023-PRC-06**

### **Arts and Heritage Hub**

This Addendum includes answers to proponents questions, and clarification.

**Issued:** August 14, 2023

This Addendum shall be read in conjunction with and considered as an integral part of the Invitation to Tender (ITT). Revisions supersede the information contained in the original ITT or previously issued Addendum. No consideration will be allowed for any extras due to any Proponents not being familiar with the contents of this Addendum. All other terms and conditions remain the same.

---

#### **REVISIONS**

*INCLUDE* attached 'General Questions' to the ITT document.

*End of Addendum #4*



# Tender Addendum TA004

Contractor Reference: RF1002

**Date** 2023.08.11

**Project** 2032 LAHH

**Client** Town of Ladysmith

The following addendum supersedes information contained in drawings, specifications and any previous addenda for the project to the extent referenced. This Addendum forms part of the tender documents and is subject to all of the conditions set out in the contract conditions.

## ITT No. 2023-PRC-06 – Arts & Heritage Hub

1. Please refer to attached document.

*Reason for Change: Clarification, Substitution of components.*

### Distribution List

Chris Barfoot, Town of Ladysmith, cbarfoot@ladysmith.ca

Ben Checkwitch, Checkwitch Poiron Architects Inc., ben@cparch.ca

**Per** Hector Alcala, Architect AIBC



**TA004 - RFI #2 – ITT No. 2023-PRC-06 – Arts & Heritage Hub**

1. Please provide specs for the three bollard luminaires along the wood deck, and one square bollard post at the main entrance.

**A: FC Outdoor Lighting FCBT690. Please see attached cut sheet.**

2. Please confirm if any new soil is required for forest restoration-naturalization areas, and specify soil type.

**A: Refer to Master Spec. Section 32 91 13. Soil Type 1P. To be confirmed by Landscape Architect.**

3. Regarding wood benches, drawing L9.03 calls for a thermally treated wood assembly including a 16" x 16" wood block. Please confirm the following:

a. Is wood pressure treated?

**Is Thermally treated wood. Can be also made of a solid block of Western Red Cedar. To be confirmed by Landscape Architect.**

b. As thermally treated wood typically comes in 2" thick, pieces would need to be laminated together to form the required block size. Please confirm if this is the intention.

**Laminated wood block is acceptable. To be confirmed by Landscape Architect.**

c. Confirm any sanding/finish requirements.

**Smooth finish. To be confirmed by Landscape Architect.**

4. Regarding 2x6 exterior wood decking, please confirm the following:

a. Is lumber to be western red cedar or yellow cedar?

**Western Red Cedar**

b. Is lumber rough-cut or dimensional?

**Can be rough-cut**

c. Confirm any sanding/finish requirements.

**Smooth finish, stained with Sansin Dec Natural Cedar 1101**

5. Regarding Cedar siding, please confirm the following:

a. The building elevations on drawing A401 show 2x6 cedar siding, however exterior wall assemblies on drawing A031 show 1x4 and 1x6 T&G vertical cedar boards. Please confirm which is correct.

**The siding are cedar boards 1x6 T&G stained.**

b. Please confirm whether Vertical Grain or Mixed Grain cedar is required for clear-coated boards, and if knots are acceptable.

**Vertical Grain, knots are not acceptable.**

c. As siding is installed vertically, are fixed length boards required or would random lengths be sufficient?

**Fixed length boards with no horizontal breaks.**

6. Regarding overhead doors, please provide a specification including the following information:

a. Are overhead doors to be motorized or manually operated?

**Manually operated.**

b. What color are the doors (clear anodized, black, white, etc.)?

**Black Anodized.**

c. Is glazing to be thermopane glass, tempered glass, Low E, tinted, etc.?

**Thermopane glass. Please see full specification in Section 08 36 00 of the Master Spec Tender Addendum 003.**

7. Mechanical specification Section 20 05 05 states, "For equipment/system demonstration and training sessions as specified in mechanical work Sections, submit an identified DVD of the session prepared by a professional photographer with construction project technical training session experience." Please confirm if this is required.

**From the architectural perspective the DVD is not necessary. Only to provide a "digital binder" with all the information and user manuals for the mechanical systems.**

8. We are requesting the Fujitsu Airstage as an approved alternate Heat Pump in lieu of Samsung. Please see attached product information for review and approval.

**To be confirmed by Mechanical Consultant.**

## FCBT690



Date:

Type:

Fixture:

Project:

Approved:

**FCBT690** Exterior die-cast aluminum bollard with right angle head position tower. Available in 42" and 36" height. Designed and built to illuminate the ground and/or pathways safely without glare. **FCBT690** has an extremely wide-throw beam pattern covering 30'–35' wide and still measuring greater than 1 foot candle. It also has a forward throw of approximately 14 feet. Matches up with FCBT690S, 24" high version.

**FCBT690- UNV- 42- 30K19L- BKE- L D**  
**Color: Black**

### SPECIFICATIONS

#### PHYSICAL

<b>dimensions</b>	42"H or 36"H x 8"W x 9"D at top (3"D at base)
<b>weight</b>	12 lbs
<b>housing</b>	marine grade, corrosion resistant, heavy gauge aluminum
<b>lens</b>	impact resistant, UV stabilized, clear, polycarbonate diffuser
<b>mounting</b>	heavy gauge base bracketing for bollard installation provides a unique mounting solution, so the tower body anchors flush to the ground without the appearance of a base plate, anchor bolts included (j-box by others)
<b>ingress protection</b>	IP66: dry, damp, or wet locations with extruded silicone gasket to seal out contaminants
<b>finish</b>	Six stage chemical iron phosphate conversion pre-treatment. Polyester powder coat finish, 18 µm Min., 5000hr salt spray test (ASTM B117) compliant with Florida / AAMA 2604 specification.

#### PERFORMANCE

<b>color temperature</b>	2700K	3000K	3500K	4000K
<b>lumen output offerings</b>	479 lm	958 lm	1436 lm	1915 lm
<b>lifetime</b>	> 70,000 hours / L70 or better			
<b>color consistency</b>	3 SDCM / 85 CRI			
<b>operating temperature</b>	-49°F to 104°F (-45°C to 40°C)			
<b>junction temperature</b>	73°C @ T <sub>a</sub> 25°C			
<b>warranty</b>	5-Year limited warranty (refer to website for details)			

#### ELECTRICAL

<b>input voltage</b>	Universal 120-277VAC   optional: 347 VAC (integral)   480 VAC (integral)
<b>power supply</b>	Integral Class II, electronic, high power factor > 94% @120V
<b>certification</b>	ETL/cETL Listed
<b>standards</b>	UL1598 / CSA C22.2 No. 250.0; UI 8750 / CSA C22.2 No. 250.13 / IES LM-79 / LM-80
<b>power consumption</b>	7W (479 lm) minimum, 26W (1915 lm) maximum
<b>dimming</b>	standard: 0-10V (10%)   optional: ELV (120V only) / DMX (integral)/DALI (integral)

Due to continuous development and improvements, specifications are subject to change without notice. FC Lighting reserves the right to change lab test details or specifications without notice. Product use certifies agreement to FC Lighting terms and conditions. FCC Series Cylinder Lights are engineered and produced in our Illinois manufacturing facility.

# Ordering Information

## ORDERING INFORMATION

FCBT690											
SERIES	VOLTAGE		HEIGHT		CCT		LUMENS		FINISH		OPTIONS
FCBT690	UNV	UNV 120V-277V	42	42"	27K	2700K	5L	479 lm (7W)	BKE	Black	CD Cane Detector
	347V	347V AC (Integral)	36	36"	3K	3000K	10L	958 lm (13W)	BZE	Bronze	LD 0-10V Dimming (Standard)
	480V	480V AC (Integral)			35K	3500K	14L	1436 lm (20W)	SLE	Silver	ELV ELV Dimming (120 Only)
					4K	4000K	19L	1915 lm (26W)	WHE	White	DMX DMX Dimming (Integral)
									CC	Custom Color	DALI DALI Dimming (Integral)
											SP20 20kV Surge Protector
											BBU Battery Backup, Integral (Not w/ ELV)
											SP20-BBU (2) 20kV Surge Protectors (1/LED driver, 1/BBU) and Battery Backup (Integral)
											HS 180° House Shield
											HS2 270° House Shield
											LAB <sup>1</sup> Less Anchor Bolt Kit - for shipment separate of Anchor Bolt Kit

## ANCHOR BOLT KITS

### A00690

Anchor Bolt Kit - Complete Anchor Bolt Kit shipped in advance of fixture.

<sup>1</sup> Note: Fixture must be mounted into FC Lighting supplied Anchor Bolt Kit shipped with or separate of fixture.

## Consult Factory for other options and configurations.

To ensure you receive proper configurations for your lighting specifications, contact us directly about any unique application requirements. This may include but not be limited to lumen output, mounting needs, or electrical requirements.

Due to continuous development and improvements, specifications are subject to change without notice. FC Lighting reserves the right to change lab test details or specifications without notice. Product use certifies agreement to FC Lighting terms and conditions. FCC Series Cylinder Lights are engineered and produced in our Illinois manufacturing facility.

## Physical



## PRODUCT DIMENSIONS - STANDARD PRODUCT

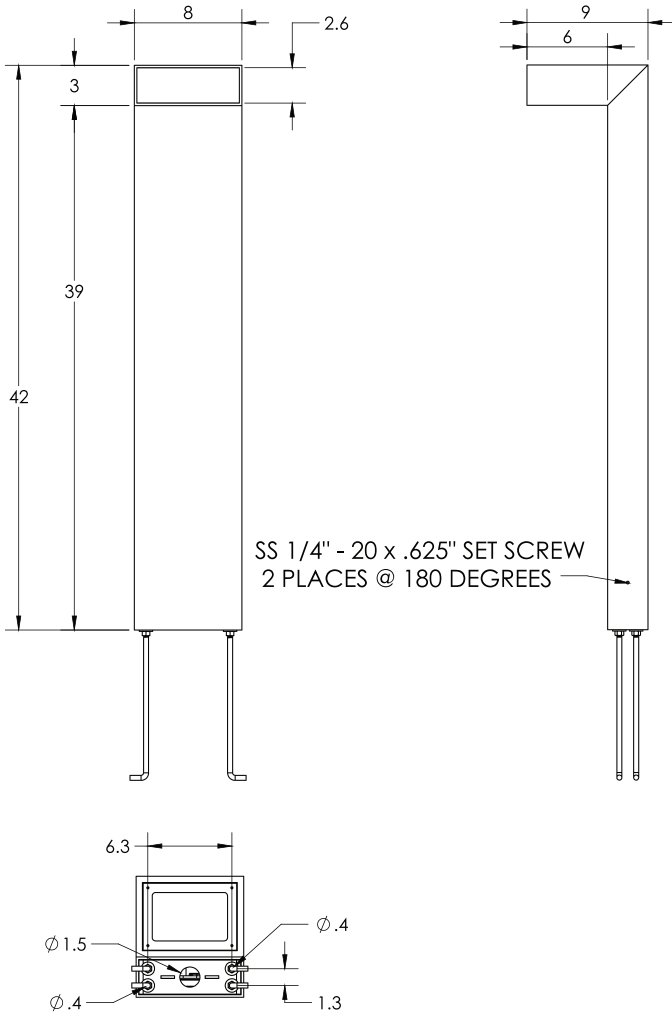

## MOUNTING

Mounting Plate Size	7.6" x 3"
Anchor Bolt Template Assembly	A00690

(Includes the below items listed)

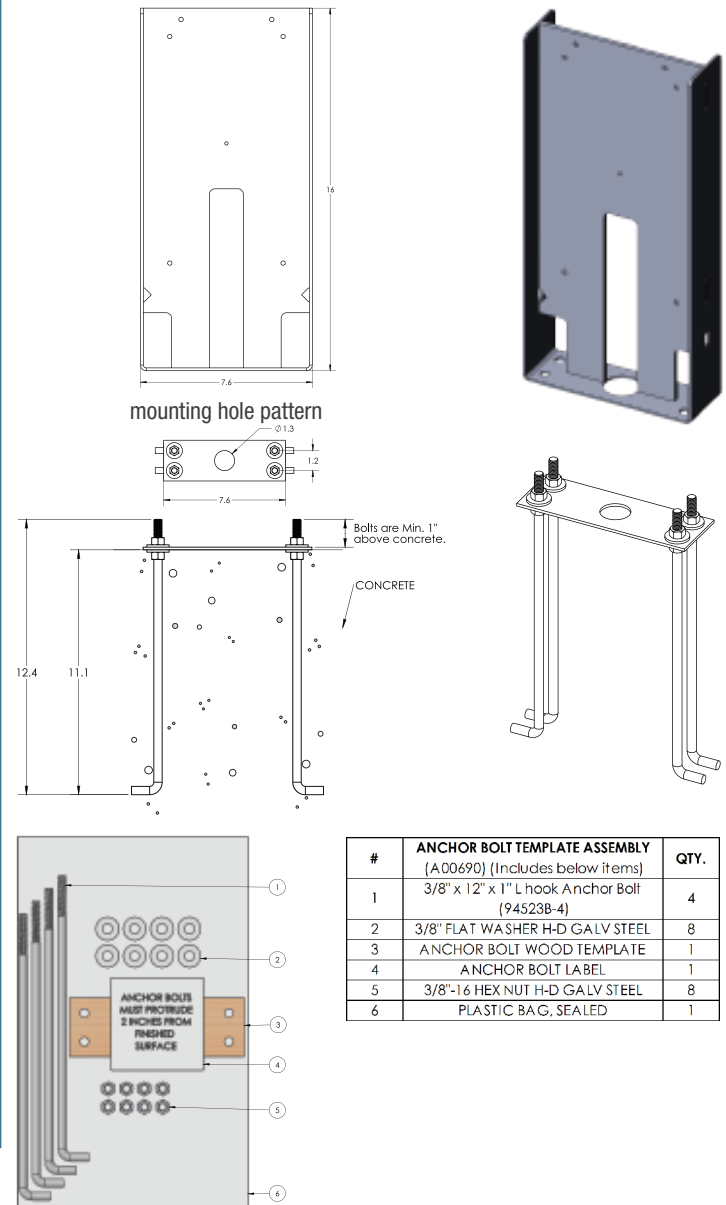

Due to continuous development and improvements, specifications are subject to change without notice. FC Lighting reserves the right to change lab test details or specifications without notice. Product use certifies agreement to FC Lighting terms and conditions. FCC Series Cylinder Lights are engineered and produced in our Illinois manufacturing facility.



# Photometry & Accessories



## OPTICAL DISTRIBUTION

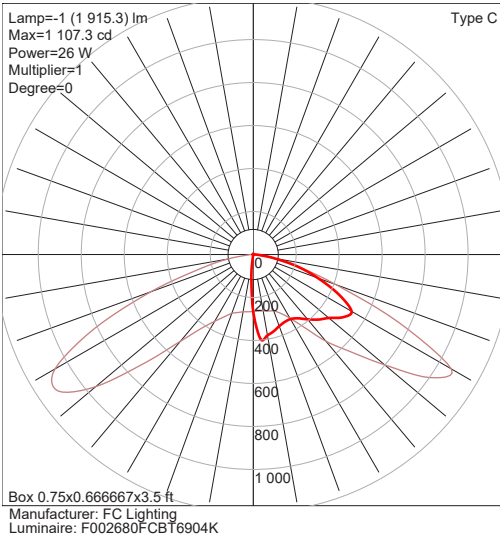

## ACCESSORIES

FIND IES FILES ON [FCLIGHTING.COM](http://FCLIGHTING.COM)

### HS - House Shield that blocks light out the sides

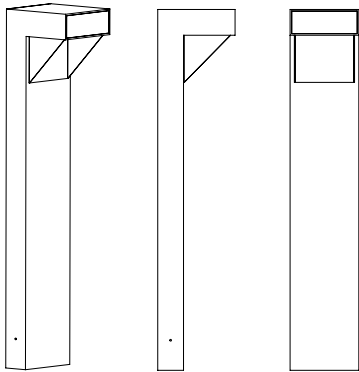

Use the 180° House Side Shield (HS) to protect beach side areas where fixtures are installed.

**HS Height:** 5.5" H

### HS2 - House Shield that blocks light out the front

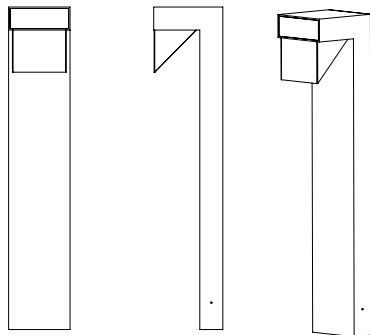

Use the (HS2) front House Shield to protect beach side areas where fixtures are installed.

**HS Height:** 5.5" H

### CD - Cane Detector

<b>foot depth</b>	add 3" D at column base
<b>foot width</b>	8" W

**SHOWS FCBT690  
W/ CANE DETECTION**

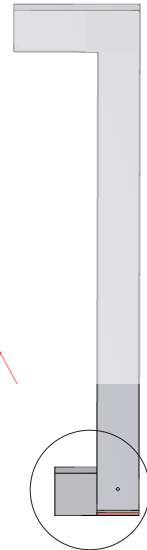

Due to continuous development and improvements, specifications are subject to change without notice. FC Lighting reserves the right to change lab test details or specifications without notice. Product use certifies agreement to FC Lighting terms and conditions. FCC Series Cylinder Lights are engineered and produced in our Illinois manufacturing facility.



US Commercial Lighting Manufacturer Since 1982

**Specification Sheet**