

NOTES:

1. CHAMBERS LOCATED ON GRAVEL ROADS OR SHOULDERS REQUIRE A 1.5m x 1.5m HOT MIX ASPHALT APRON, 50 THICK
2. THIS APPLICATION SHALL ONLY BE USED IN STATUTORY RIGHTS-OF-WAY WITH THE APPROVAL OF THE DIRECTOR OF ENGINEERING AND PUBLIC WORKS
3. PLACE TAR PAPER OR FILTER CLOTH OVER DRAIN ROCK PRIOR TO BACKFILL
4. CHAMBER MUST BE SELF DRAINING
5. ONLY PRODUCTS APPROVED BY THE TOWN ENGINEER WILL BE ACCEPTED FOR INSTALLATION

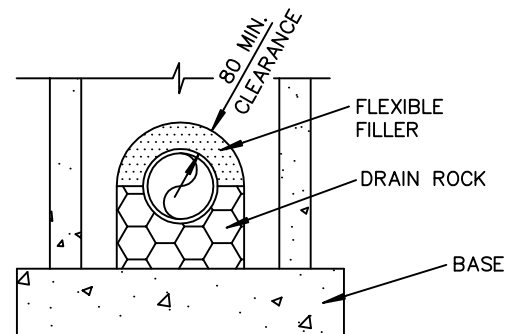

DETAIL

DIMENSIONS ARE IN MILLIMETRES UNLESS OTHERWISE NOTED



TOWN OF LADYSMITH
ENGINEERING STANDARD

AIR RELEASE VALVE ASSEMBLY
TYPE 1

DATE: JAN. 1999

APP. BY:

DRAWING No.

W8

REV.

01