

SECTION A-A

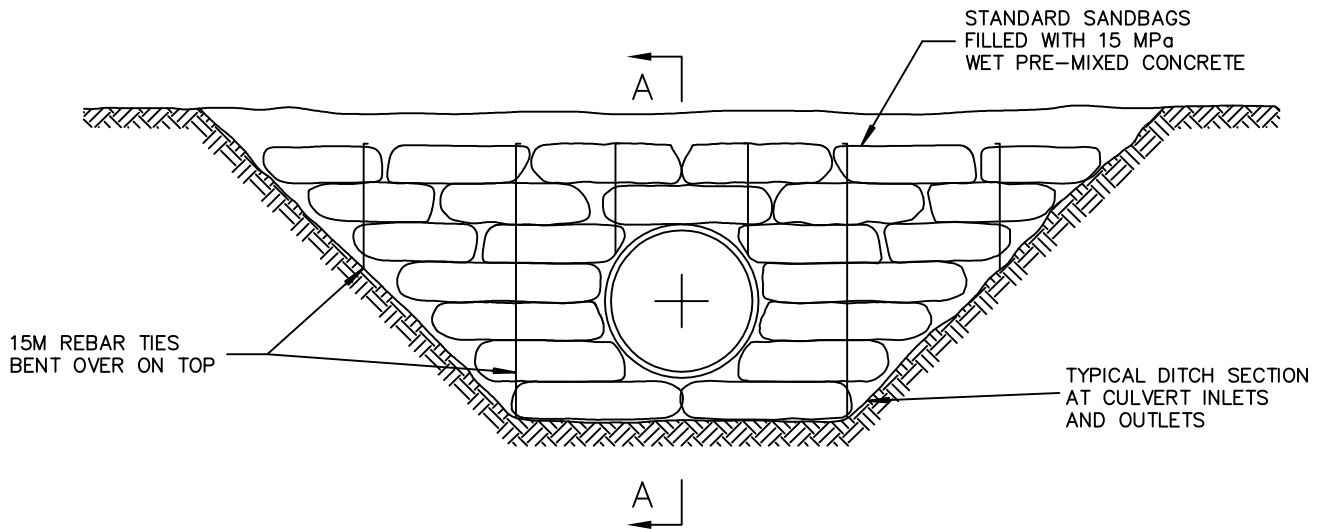

ELEVATION

NOTES:

1. IF THE HORIZONTAL DIRECTION OF FLOW AT CULVERT INLETS AND OUTLETS EXCEEDS 30° , THEN THE SANDBAG BULKHEADS REQUIRE CURVED WING WALLS TO FUNNEL THE FLOW.

USE ONLY FOR DRIVEWAY CULVERTS AND HYDRANT ACCESS CROSSINGS UNLESS APPROVED BY THE CITY ENGINEER.

DIMENSIONS ARE IN MILLIMETRES UNLESS OTHERWISE NOTED



TOWN OF LADYSMITH
ENGINEERING STANDARD

SANDBAG HEADWALL FOR
CULVERT INLETS & OUTLETS

DATE: MAY 2002

APP. BY:

DRAWING No.
D16A

REV.
00