

CURB WITH INTEGRAL GUTTER

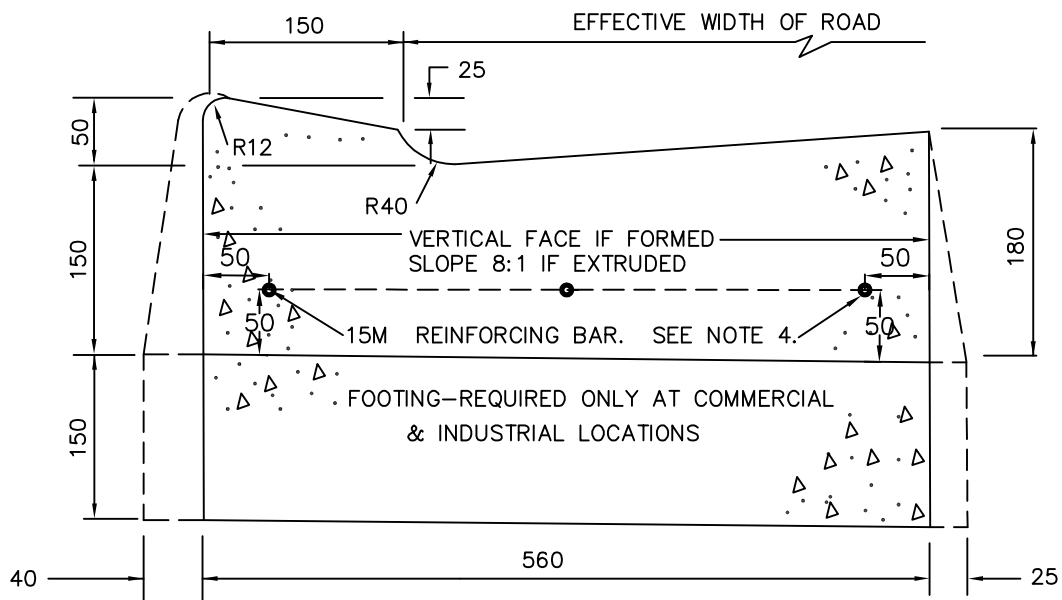

DROP CURB WITH INTEGRAL GUTTER

NOTES:

1. CURB AND GUTTER TO BE BEDDED ON 100 COMPACTED THICKNESS OF 20 MINUS CRUSH GRAVEL.
2. FOR CONCRETE DETAILS REFER TO SECTION 10.
3. THE LENGTH OF TRANSITION FROM ONE TYPE OF CURB TO ANOTHER SHALL BE THE GREATEST OF:
 - a) 50 x DIFFERENCE IN OVERALL CURB HEIGHTS
 - b) 25 x DIFFERENCE IN GUTTER WIDTHS
 - c) 2.0 METERS
4. REINFORCING BARS OR CONCRETE FOOTING REQUIRED FOR LANE ACCESSES AND FOR COMMERCIAL AND INDUSTRIAL DRIVEWAY ACCESSES.

DIMENSIONS ARE IN MILLIMETRES UNLESS OTHERWISE NOTED



TOWN OF LADYSMITH
ENGINEERING STANDARD

NON MOUNTABLE MONOLITHIC
CURB AND GUTTER

DATE: JAN. 93

APP. BY:

DRAWING No.

C2

REV.

00