

TYPICAL STAIRWAY HANDRAIL

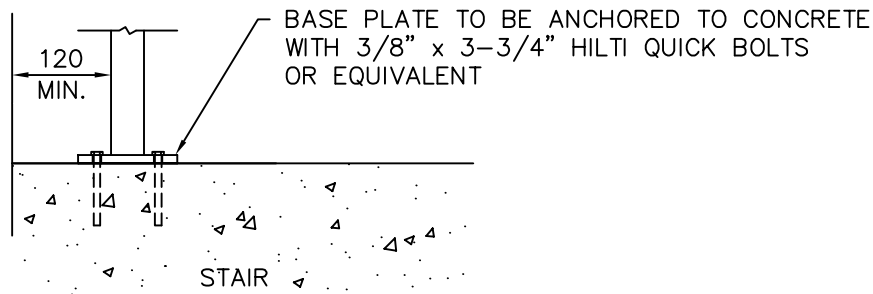
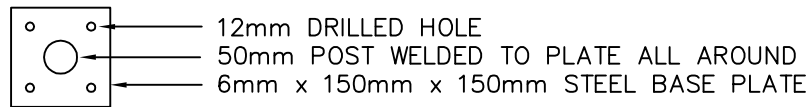

ATTACHED MOUNTING DETAIL

NOTES:

1. ALL HANDRAILS AND POSTS SHALL BE 50 mm (2") GALV. STEEL PIPE
2. ALL WELDED JOINTS ARE TO BE COATED WITH GALVACON OR EQUIVALENT
3. ALL JOINTS SHALL BE MITRED, WELDED ALL AROUND AND FILED SMOOTH
4. ALL BENDS SHALL BE SMOOTH CIRCULAR CURVES

DIMENSIONS ARE IN MILLIMETRES UNLESS OTHERWISE NOTED



TOWN OF LADYSMITH
 ENGINEERING STANDARD

STAIRWAY HANDRAIL

DATE: JAN. 1999

APP. BY:

DRAWING No.

C14

REV.

00